



ARCY-Line: CADM Commercial Downlights

2-Piece Design + Adjustable Beam Angle



Detail Specification:

- Finish: White Smooth & Clear-Specular Options
- Round or Square Trims Available
- Wet Location Rated
- Field Adjustable Beam Angle: 24-45°
- Chip: COB, R9 >50, CRI >90, UGR<16
- 3 Step MacAdam Ellipses
- Operating Temperature: -40° - 114° F
- Lens: Frosted PC, non-yellowing
- Average life (L70) of 70,000 hours

Applications:

- General Recessed Lighting
- Residential & Multifamily
- Office, Hallways and Meeting Rooms
- Education, Healthcare, Retail, Hospitality
- Commercial Lighting

Product Information:

- Metal housing and trim for better heat dissipation
- Module twists and locks into the trim
- SnapTrim Canless: Spring clips with remote j-box eliminates can
- Deep reflector lens reduces glare and optimizes even beam distribution
- 3M20, 3M30, 3M35: Compatible with 4", 6", 8", 10" Trims
- 3M55: Compatible with 6", 8", 10" Trims
- Select-n-Switch Technology: 5-CCT + 3-Power Selectable

Driver Options:

- 120-277V 0-10V Dimmable down to 1%
- THD: <20% (+/-5% tolerance), PF >0.9, 50/60Hz
- Built in 2.5Kv Surge Protector
- Flicker Free

Mounting & Installation:

- Cut Out Dimensions:
 - 4": 4-3/4" -- 5-1/2"
 - 6": 6-1/8" -- 7-3/16"
 - 8": 7-1/2" -- 8-7/8"
 - 10": 9" -- 10"
- Optional new construction plate available
- This fixture does not fit into a recessed can
- No housing needed in remodel applications, tension clips mount into 1/2" to 1.5" thick ceiling
- Can be removed from below the ceiling for service or replacement
- Pre-wired junction box with circuit wiring built in (3 in / 3 out)

Certifications:

- ETL Listed for USA and CA
- Energy Star Certified
- CA Title 24 JA8-2022 CEC Listed
- 5 Year Limited Warranty
- FCC CFR 47, GCC Part 15, Subpart B:2017
- 3M20 Module is IC Rated and ASTM-E283 Air-Tight
- 3M30, 3M35, 3M55 is Non-IC



Black Trim Reflector



Square Reflector

PICK YOUR MODEL (REQ'D)

| Modules | Voltage ¹ | Emergency |
|--|-------------------------|--------------------------------|
| LED-CADM-3M20-5CCT 10/12/20W • 750/1,000/1,500lm | UNV 120-1277V | (Blank) No Emergency |
| LED-CADM-3M30-5CCT 20/24/30W • 1,700/2,000/2,400lm | HV 347-480V | Backup |
| LED-CADM-3M55-30K 32/40/55W • 3,200/4,000/5,000lm | | EMB Emergency |
| LED-CADM-3M55-35K 32/40/55W • 3,200/4,000/5,000lm | | Backup |
| LED-CADM-3M55-40K 32/40/55W • 3,200/4,000/5,000lm | | |

1. HV: Step down transformer into 4" j-box

PICK YOUR TRIM (REQ'D)

| Trim ² | Goof Ring | Optional Accessories (Order Separately) | New Construction Plates | Emergency Backup ³ | Junction Box |
|--|----------------------------------|---|--|---|--------------|
| CADM-4-CSH² 4" Round Clear-Specular Haze Reflector / White Flange | GR-4-WH 4-8" Width | C4-NC-RI-JJBX 4" plate w/ handing bars + j-box (Round Models) | LED-EMB-8W-HV-0/10V-2P 8W Emergency Backup | JBOX-ALM Junction box with 4 1/2" knockouts | |
| CADM-4-WH² 4" Round White Reflector White Flange | GR-6-WH 6.3-10" Width | C6-NC-RI-JJBX 6" plate w/ handing bars + j-box (Round Models) | LED-EMB-15W-HV-0/10V-2P 15W Emergency Backup | | |
| CADM-4-CSH-SQ² 4" Square Clear-Specular Haze Reflector / White Flange | GR-8-WH 8-12.5" Width | C8/10-NC-RI-JJBX 8 & 10" plate w/ handing bars + j-box (Round Models) | LED-EMB-25W-HV-0/10V-2P 25W Emergency Backup | | |
| CADM-4-CSH-BLK² 4" Round Clear-Specular Haze Reflector / Black Flange | GR-10-WH 9-14.1" Width | CUNV-NC-RI-JJBX 4, 6, 8, 10" plate w/ handing bars + j-box (Round Models) | | | |
| CADM-6-CSH 6" Round Clear-Specular Haze Reflector / White Flange | | CUNV-NC-SQ-RI-JJBX 4, 6, 8" plate w/ handing bars + j-box (Square Models) | | | |
| CADM-6-WH 6" Round White Reflector White Flange | | CUNV-NC-ICAT-7H 4, 6, 8" Universal plate w/ handing bars (Round Models) | | | |
| CADM-6-CSH-SQ 6" Square Clear-Specular Haze Reflector / White Flange | | CUNV-NC-ICAT-6SQ 4, 6, 8" Universal plate w/ handing bars (Square Models) | | | |
| CADM-6-CSH-BLK 6" Round Clear-Specular Haze Reflector / Black Flange | | CUNV-JBX-RI-XL 4, 6, 8" Universal tough in plate. Extra long. | | | |
| CADM-8-CSH 8" Round Clear-Specular Haze Reflector / White Flange | | | | | |
| CADM-8-WH 8" Round White Reflector White Flange | | | | | |
| CADM-8-CSH-SQ 8" Square Clear-Specular Haze Reflector / White Flange | | | | | |
| CADM-8-CSH-BLK 8" Round Clear-Specular Haze Reflector / Black Flange | | | | | |
| CADM-10-CSH 10" Round Clear-Specular Haze Reflector / White Flange | | | | | |
| CADM-10-WH 10" Round White Reflector / White Flange | | | | | |

2. Only compatible with 3M20 & 3M30
 3. Field installable. Lasts 90 minutes.

Specs and model numbers are subject to change with or without notice.

ARCY-Line: CADM Commercial Downlights

2-Piece Design + Adjustable Beam Angle

FEATURES



DIMENSIONS

DOWNLIGHT MODULE

3M55

Compatible with 6", 8", 10"

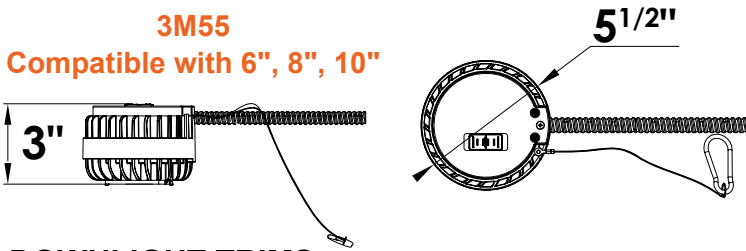

3M20, 3M30 & 3M35
Compatible with 4", 6", 8", 10"

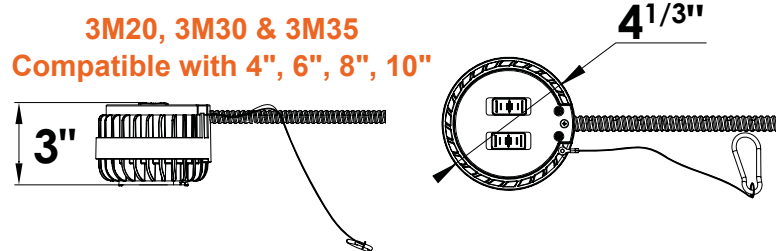

DOWNLIGHT TRIMS

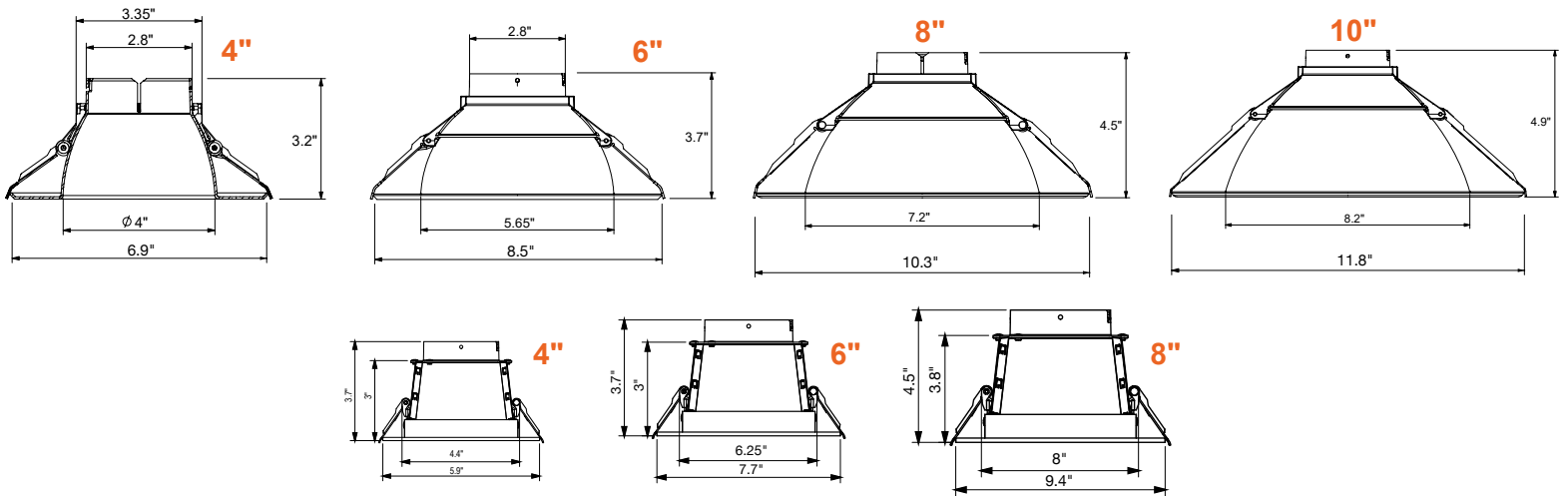

ACCESSORIES

TRIMS



CSH



WH



BLK



SQ

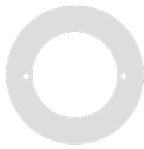

GR-4-WH
GR-6-WH
GR-8-WH
GR-10-WH



C4-NC-RI-J-JBX
17" W x 6.5" D x 3.5" H
5" Hole
14" Min. Extend
25" Max. Extend
(Assembly Required)

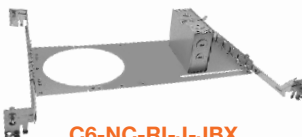

C6-NC-RI-J-JBX
18.5" W x 9" D x 4" H
6.25" Hole
14.25" Min. Extend
25" Max. Extend
(Assembly Required)



C8/10-NC-RI-J-JBX
18.5" W x 12" D x 4" H
8" Hole
14" Min. Extend
25" Max. Extend
(Assembly Required)



CUNV-NC-RI-J-JBX
21.2" W x 12" D x 1.6" H
(Assembly Required)

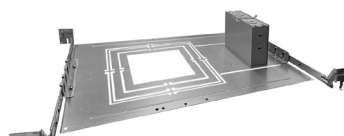

CUNV-NC-SQ-RI-J-JBX
21.2" W x 12" D x 1.6" H
(Assembly Required)

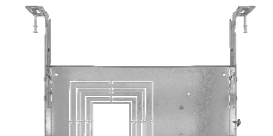

CUNV-NC-ICAT-6SQ
Universal Pre-Mounting Plate
13.75" x 14"



CUNV-NC-ICAT-7H
Universal Pre-Mounting Plate
13 7/8" x 15 1/8"



LED-EMB-8W-HV-0/10V-2P
LED-EMB-15W-HV-0/10V-2P
LED-EMB-25W-HV-0/10V-2P



CUNV-JBX-RI-XL
7" x 26"

DOWNLIGHT MODULE

| Model | Voltage | Watts | Lumens | Color | CRI |
|------------------------|----------|-----------|------------------|-----------------|-----|
| LED-CADM-3M20-5CCT-UNV | 120-277V | 10/12/20w | 750/1000/1500lm | 27/30/35/40/50K | >90 |
| LED-CADM-3M30-5CCT-UNV | 120-277V | 13/20/35w | 1700/2000/2400lm | 27/30/35/40/50K | >90 |
| LED-CADM-3M55-30K-UNV | 120-277V | 32/40/55w | 3200/4000/5000lm | 3000k | >90 |
| LED-CADM-3M55-35K-UNV | 120-277V | 32/40/55w | 3200/4000/5000lm | 3500k | >90 |
| LED-CADM-3M55-40K-UNV | 120-277V | 32/40/55w | 3200/4000/5000lm | 4000k | >90 |

TRIMS

| Model | Description |
|----------------|--|
| CADM-4-CSH | 4" Round Clear-Specular Haze Reflector / White Flange |
| CADM-4-WH | 4" Round White Reflector / White Flange |
| CADM-4-CSH-BLK | 4" Round Clear-Specular Haze Reflector / Black Flange |
| CADM-4-CSH-SQ | 4" Square Clear-Specular Haze Reflector / White Flange |
| CADM-6-CSH | 6" Round Clear-Specular Haze Reflector / White Flange |
| CADM-6-WH | 6" Round White Reflector / White Flange |
| CADM-6-CSH-BLK | 6" Round Clear-Specular Haze Reflector / Black Flange |
| CADM-6-CSH-SQ | 6" Square Clear-Specular Haze Reflector / White Flange |
| CADM-8-CSH | 8" Round Clear-Specular Haze Reflector / White Flange |
| CADM-8-WH | 8" Round White Reflector / White Flange |
| CADM-8-CSH-BLK | 8" Round Clear-Specular Haze Reflector / Black Flange |
| CADM-8-CSH-SQ | 8" Square Clear-Specular Haze Reflector / White Flange |
| CADM-10-CSH | 10" Round Clear-Specular Haze Reflector / White Flange |
| CADM-10-WH | 10" Round White Reflector / White Flange |

GOOF RING

| Accessory Model | Description |
|-----------------|--|
| GR-4-WH | 4" Goof Ring, Inner Dim: 4.9" Outer Dim: 6.5" |
| GR-6-WH | 6" Goof Ring, Inner Dim: 6.3" Outer Dim: 10.5" |
| GR-8-WH | 8" Goof Ring, Inner Dim: 8" Outer Dim: 12.5" |
| GR-10-WH | 10" Goof Ring, Inner Dim: 9" Outer Dim: 14.1" |

NEW CONSTRUCTION PLATES

| Accessory Model | Description |
|---------------------|---|
| C4-NC-RI-J-JBX | 4" plate w/ hanging bars + j-box (Round Models) |
| C6-NC-RI-J-JBX | 6" plate w/ hanging bars + j-box (Round Models) |
| C8/10-NC-RI-J-JBX | 8 & 10" plate w/ hanging bars + j-box (Round Models) |
| CUNV-NC-RI-J-JBX | 4, 6, 8, 10" plate w/ hanging bars + j-box (Round Models) |
| CUNV-NC-SQ-RI-J-JBX | 4, 6, 8" plate w/ hanging bars + j-box (Square Models) |
| CUNV-NC-ICAT-7H | 4, 6, 8" Universal plate w/ hanging bars (Round Models) |
| CUNV-NC-ICAT-6SQ | 4, 6, 8" Universal plate w/ hanging bars (Square Models) |
| CUNV-JBX-RI-XL | 4, 6, 8" Universal tough in plate. Extra long. |

BATTERY BACK-UP

| Accessory | Description |
|-------------------------|----------------------|
| LED-EMB-8W-HV-0/10V-2P | 8W Emergency Backup |
| LED-EMB-15W-HV-0/10V-2P | 15W Emergency Backup |
| LED-EMB-25W-HV-0/10V-2P | 25W Emergency Backup |

JUNCTION BOX

| Accessory | Description |
|-----------|------------------------------------|
| JBOX-ALM | Junction box with 4 1/2" knockouts |

TESTED COMPATIBLE DIMMERS

Other dimmers may be compatible but have not been tested. Please contact us for more information.

| Brand | Item# | Brand | Item# |
|---------|-------------------|-------------------|-------------------|
| Synergy | ISD BC 120/277 WH | Leviton | IP710-DLZ |
| Eaton | SF10P-W | Lithonia Lighting | ISD BC 120/277 WH |
| Lutron | DVSTV-WH | | |



J-BOX ALM
4.46" W x 3.04" D x 1.37" H