

# SnapTrim-Line: 4" Regressed Downlights

## Fire Rated



### Detail Specifications:

- Fire Rated: 2 hour fire rating
- Finish: White, Black, Custom
- IP54 Wet Location Rated
- Beam Angle: 38° standard, other options available
- Chip: COB Chip, R9 >50, CRI >90
- 3 Step MacAdam Ellipses
- Operating Temperature: -40° - 114° F
- Lens: Frosted, non-yellowing
- Average life (L70) of 50,000 hours

### Applications:

- General Recessed Lighting
- Residential & Multifamily
- Office and Meeting Rooms
- Education, Healthcare, Retail, Hospitality

### Product Information:

- 5-CCT Selectable: 27/30/35/40/50K
- Various sizes, finishes, and trims available
- Standard white round trim included: optional trims available
- Metal housing and trim for better heat dissipation
- Optional emergency backup available: delivers full lumens in EM mode up to 25W
- SnapTrim Canless: Spring clips with remote j-box eliminates can

### Driver Options:

- 120V Triac Dimmable
- Built in 2.5Kv Surge Protector
- Flicker Free

### Mounting & Installation:

- Cut Out Dimension: 3-3/4"
- Optional new construction plate available
- This fixture does not fit into a recessed can
- No housing needed in remodel applications, tension clips mount into 1/2" to 1.5" thick ceiling
- Can be removed from below the ceiling for service or replacement
- Pre-wired junction box with circuit wiring built in (3 in/ 3 out)

### Certifications:

- ETL Listed for USA and CA
- Energy Star Certified
- CA Title 24 JA8-2022 CEC Listed
- 5 Year Limited Warranty
- FCC CFR 47, GCC Part 15, Subpart B:2017
- IC Rated and ASTM-E283 Air-Tight
- Complies with UL 263, ASTM E119, CAN ULC S101

| Series  | Emergency           | Beam Angle     |
|---|---------------------|----------------|
| <b>LED-DLJBX-4RG-15W-5CCT-FR-WH-R</b> -<br>15W • 1,100lm • 120V |                     |                |
|   | <b>(Blank)</b>      | <b>(Blank)</b> |
|   | No Emergency Backup | 38° Degree     |
|   | <b>EMB</b>          | 24° Degree     |
|   | Emergency Backup    | <b>60D</b>     |
|   |                     | 60° Degree     |

| Optional Accessories (Order Separately)       |   |  |   |                                       |
|---|---|--|---|---------------------------------------|
| Trim Options                                  | New Construction Plates                                     | Emergency Backup (field install) 1       | Goof Ring   | Optics                                |
| <b>DLJBX-4RG-TRIM-BLK-R</b><br>Black Round    | <b>CUNV-NC-ICAT-7H</b><br>Universal Plate with Hanging Bars | <b>JBX-EXT-6'-2PIN</b><br>6' Extension   | <b>LED-EMB-25W-HV -0/10V-2P</b><br>Up to 24W fixtures | <b>GR-4-WH -24D</b><br>4"-8" Width    |
| <b>DLJBX-4RG-TRIM-BRZ-R</b><br>Bronze Round   | <b>C4-JBX-RI</b><br>4" Rough in plate                       | <b>JBX-EXT-10'-2PIN</b><br>10' Extension |   | <b>OPTIC-63X22 -60D</b><br>60° Degree |
| <b>DLJBX-4RG-TRIM-WH-SQ</b><br>White Square   | <b>CUNV-JBX-RI-XL</b><br>Universal Rough In                 | <b>JBX-EXT-12'-2PIN</b><br>12' Extension |   |                                       |
| <b>DLJBX-4RG-TRIM-BLK-SQ</b><br>Black Squared |   |  |   |                                       |
| <b>DLJBX-4RG-TRIM-BRZ-SQ</b><br>Bronze Square | Plate Extra Long  |  |   |                                       |

1. Field installable. Lasts 90 minutes.

# SnapTrim-Line: 4" Regressed Downlights

Fire Rated

## FEATURES

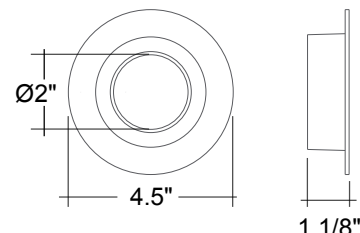
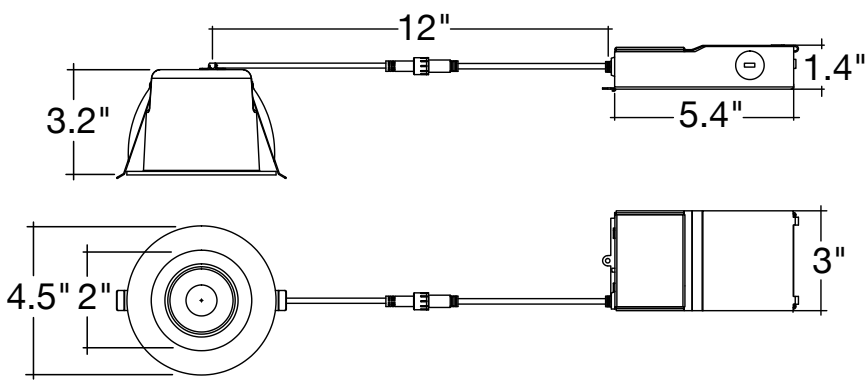

4" Round Trim

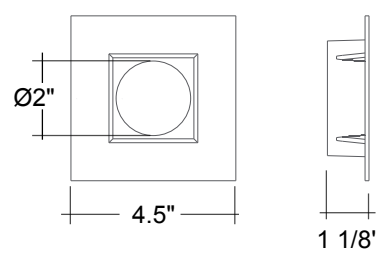
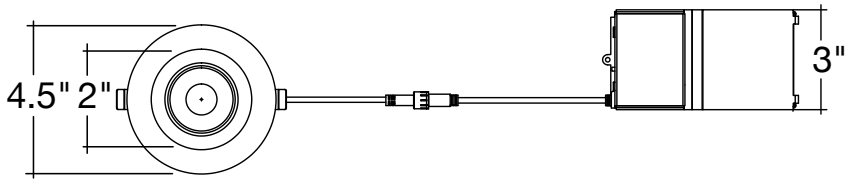

4" Square Trim

# SnapTrim-Line: 4" Regressed Downlights

## Fire Rated

### ACCESSORIES



White (-WH)  
Included



White (-WH-SQ)



Bronze



Bronze (-BRZ-SQ)



Black (-BLK-R)



Black (-BLK-SQ)

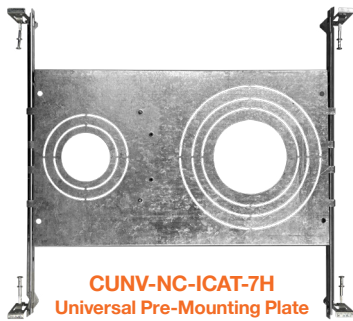

**CUNV-NC-ICAT-7H**  
Universal Pre-Mounting Plate  
13 7/8" x 15 1/8"

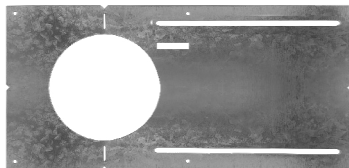

**C4-JBX-RI**  
4" Rough In Plate  
6 1/2" x 17 1/4"

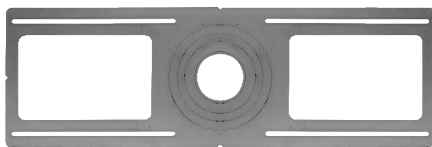

**CUNV-JBX-RI-XL**  
7" x 26"



**JBX-EXT**  
6' / 10' / 12' Extension Cable



**LED-EMB-25W-HV-0/10V-2P**

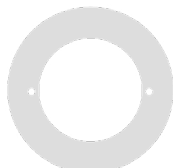

**GR-4-WH**



**OPTIC-63X22-24D**  
**OPTIC-63X22-60D**

| Model                          | Voltage | Watts | Lumens | Color           | CRI |
|--------------------------------|---------|-------|--------|-----------------|-----|
| LED-DLJBX-4RG-15W-5CCT-FR-WH-R | 120V    | 15w   | 1100   | 27/30/35/40/50K | >90 |

### TRIMS

| Accessory              | Description                            |
|------------------------|--|
| Add '-EMB-' to model # | Emergency Backup (External 25W)        |
| DLJBX-4RG-TRIM-WH-SQ   | 4" Regressed Gimbal White Square Trim  |
| DLJBX-4RG-TRIM-BLK-R   | 4" Regressed Gimbal Black Round Trim   |
| DLJBX-4RG-TRIM-BLK-SQ  | 4" Regressed Gimbal Black Square Trim  |
| DLJBX-4RG-TRIM-BRZ-R   | 4" Regressed Gimbal Bronze Round Trim  |
| DLJBX-4RG-TRIM-BRZ-SQ  | 4" Regressed Gimbal Bronze Square Trim |

### CONSTRUCTION PLATES

| Accessory       | Description   |
|-----------------|---|
| CUNV-NC-ICAT-7H | 1" 2"3" 3.5" 4" 5" 6" Universal Pre-Mounting New Construction Plate |
| C4-JBX-RI       | 4" Rough In Plate   |
| CUNV-JBX-RI-XL  | Universal tough in plate (Extra Long)                               |

### EXTENSION CABLE

| Accessory        | Description         |
|------------------|---------------------|
| JBX-EXT-6'-2PIN  | 6" Extension Cable  |
| JBX-EXT-10'-2PIN | 10" Extension Cable |
| JBX-EXT-12'-2PIN | 12" Extension Cable |

### BATTERY BACK-UP

| Accessory               | Description        |
|-------------------------|--------------------|
| LED-EMB-25W-HV-0/10V-2P | Up to 24W fixtures |

### OPTICS

| Accessory       | Description |
|-----------------|-------------|
| OPTIC-63X22-24D | 24 Degree   |
| OPTIC-63X22-60D | 60 Degree   |

### GOOF RING

| Accessory | Description |
|-----------|-------------|
| GR-4-WH   | 4-8" Width  |

### TESTED COMPATIBLE DIMMERS

Other dimmers may be compatible but have not been tested. Please contact us for more information.

#### TRIAC/ELV Dimmers

| Lutron     | Leviton    | Legrand | Cooper         |
|------------|------------|---------|----------------|
| AYCL-153P  | NTELV-300P | 6633    | ADTP703TU 9540 |
| DV-600PR   | S-600P     | 6674    | H703PTW DAL06P |
| DVCL-153P  | CT-600P    | 6602    |                |
| MACL-153MH | CTCL-153P  | IPL06   |                |
| MRF2-6CL   | TG-600P    |         |                |
| D-600P     | TCCL-153P  |         |                |