

Installation Instructions

⚠ WARNING

Turn the power off from electrical panel before installation or maintenance.

- Do not modify this fixture, any modifications may render the product unsafe and void warranty.
- This product is suitable for wet locations.

FIXTURE INSTALLATION

- STEP 1:** Measure distance from walls and mark position of fixture to be installed on the ceiling.
- STEP 2:** Carefully mark the position of the hole template in accordance to cut hole size on desired location.
- STEP 3:** Carefully cut hole in ceiling (Fig. 1)
- STEP 4:** Electrical connections
- STEP 5:** Select color temperature
- STEP 6:** Connect J-Box to light fixture by connecting the quick male and female connector (Fig. 2)
- STEP 7:** Pass the J-Box and attached cable through the hole and place on straight surface inside the ceiling cavity (Fig. 3)
- STEP 8:** Push the spring clip up to fit inside the cut hole. (Fig. 4)
- STEP 9:** Push the fixture through the cut hole until the trim is flush with the ceiling. Spring will lock to hold the trim in place (Fig. 5)

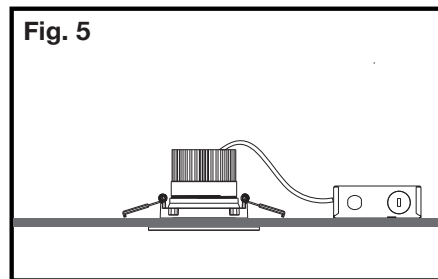
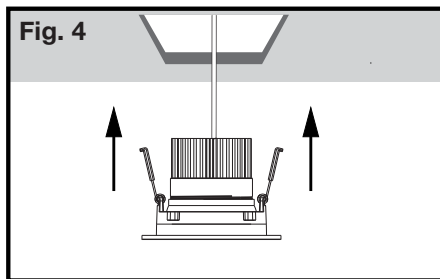
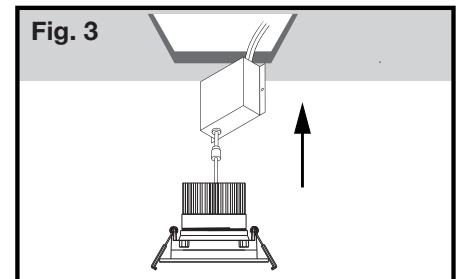
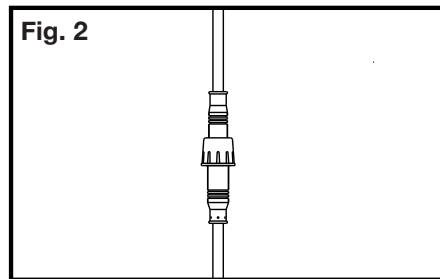
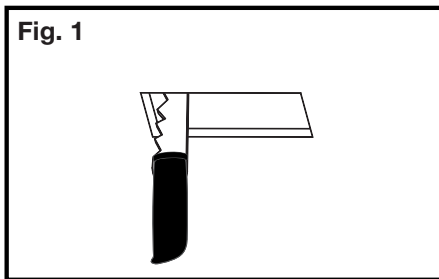
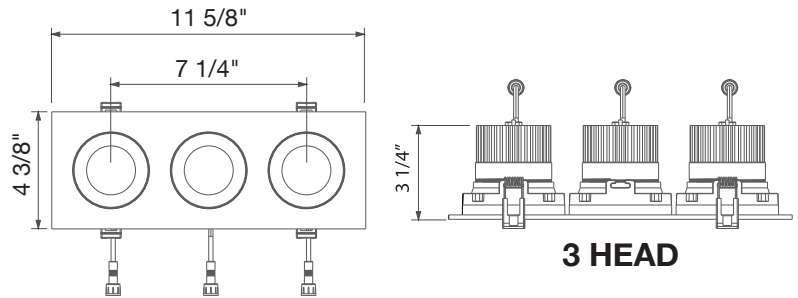
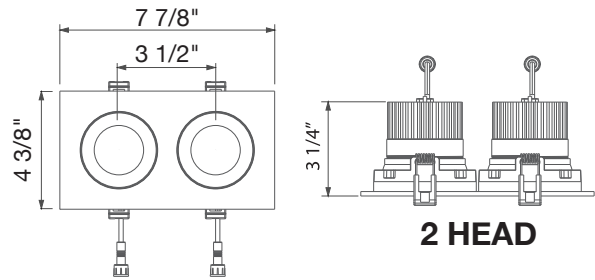
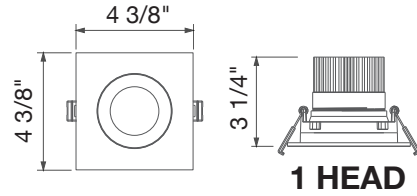

1 HEAD

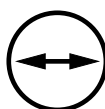

CUTOUT:
3.75"

2 HEAD

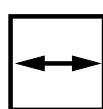

CUTOUT:
7.25" x 3.75"

3 HEAD

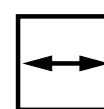

CUTOUT:
10.82" x 3.75"