

# Undercabinet Installation Instructions

## MOUNTING FIXTURE

1. Remove captive mounting screw covers.
2. Place fixture in desired position and drive mounting screws securely. In some installations it may be desired to drill a pilot hole for the screws.
3. Replace the captive mounting screw cover.

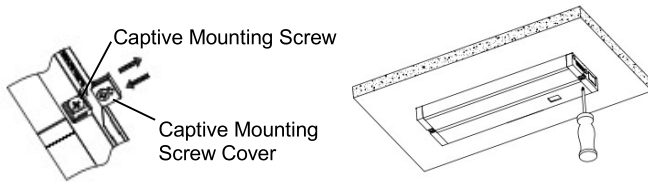

## POWER CORD CONNECTION

Remove the electrical port cover and insert the power cord into INPUT electrical port. (Power cord sold separately)

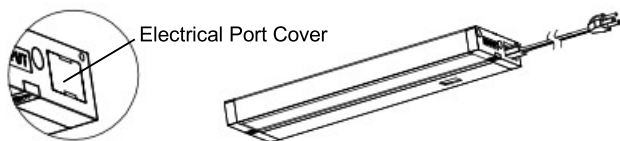

## SWITCH CONNECTION

1. Open the cover on the back using a flat and sharp tool. (Fig. 1)
2. Unscrew a P2 connector where 4 black wires are connected. (Fig. 2)
3. Use a P2 connector (provided) and connect an INPUT port wire (Black) and a wire from the switch. (Fig. 2)
4. Use another P2 connector (provided) and connect a wire from Switch and the remaining black wires. (Fig. 2)
5. Replace the cover.

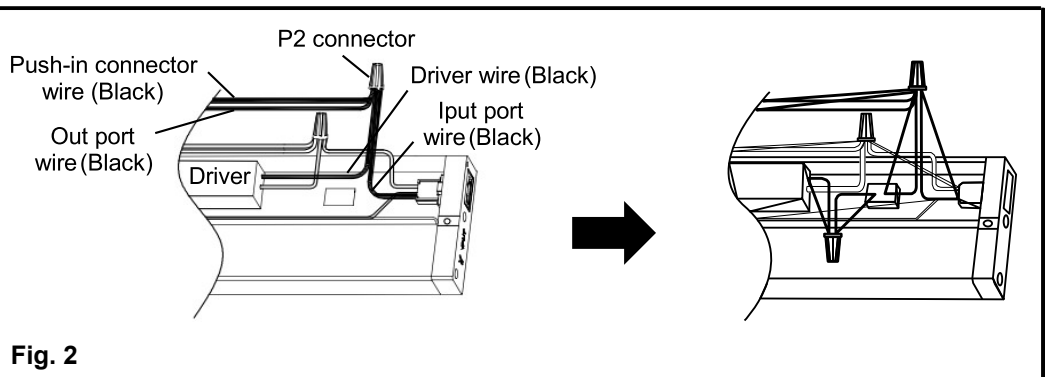
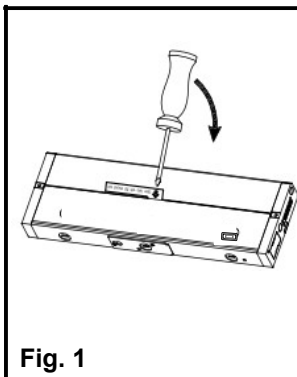

## JOINING MULTIPLE FIXTURES

### USING JUMPER CORD

1. Remove electrical port covers.
2. Connect INPUT of jumper cord to INPUT of electrical port.
3. Connect OUTPUT of jumper cord to OUTPUT of electrical port.

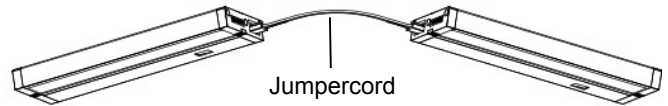

### USING END-TO-END CONNECTOR

1. Remove electrical port covers.
2. Connect INPUT of end-to-end connector to INPUT of electrical port.
3. Connect OUTPUT of end-to-end connector to OUTPUT of electrical port.

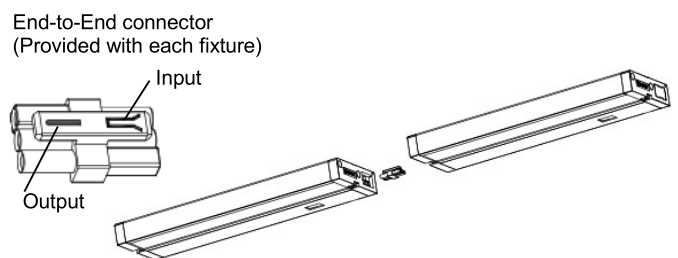

## WIRING CONNECTION THROUGH A REAR ACCESS DOOR

1. Loosen screw that secures rear access door and remove the door from key hole by just a slide (Fig. 3)
2. Assemble 3/8" die-cast connector into rear access door (Fig. 4) and push supply cable through the die-cast connector. (Fig. 5)
3. Inside fixture are three wires with push-in connectors. Carefully pull these out of fixture. Do not pull with excessive force.
4. Insert each of the three wires from the supply cable into each of the three push-in connectors with color wires. Black to Black, White to White and Green (Earth Wire) to green.
5. Neatly push wires and push-in connectors into opening the back of the fixture.
6. Close the rear access door and tighten screw.

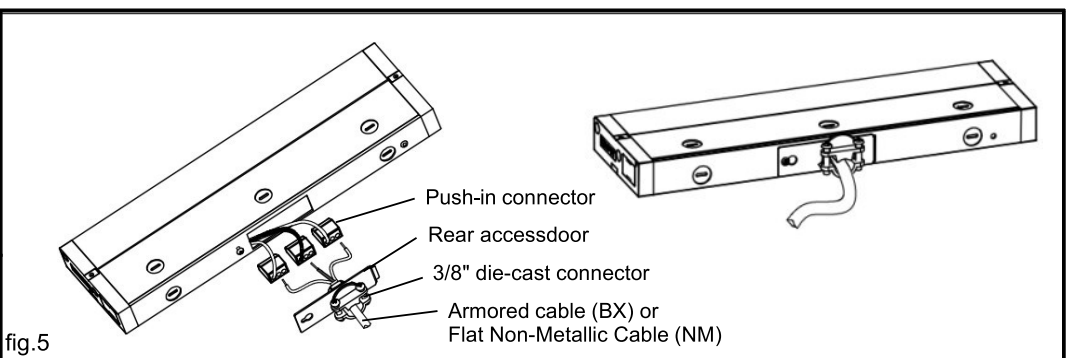
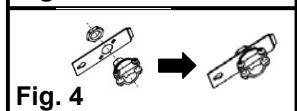
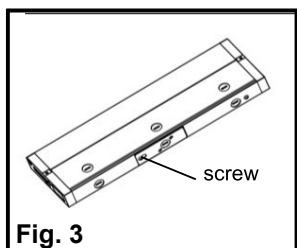

1. Open a cover in the back using a flat and sharp tool.
2. Remove knockout and assemble 3/8" die-cast connector.
3. Push supply cable through the die-cast connector and connect wires using push-in connector.
4. Replace the cover and close.