



Prismatic Lens LED Wraps



Detail Specification:

- Finish: White
- IP Rating: Damp Location (IP44)
- Beam Angle: 110°
- Chip: SMD 2835, R9 >50, CRI >80
- Operating Temperature: -40° - 122° F
- Lens: Clear Ribbed Plastic
- Average life (L70) of 50,000 hours

Applications:

- Stairwell & Hallways
- Utility & Storage
- Garage Structures
- Office and Meeting Rooms
- Shop Lighting
- Residential, Commercial and Industrial

Product Information:

- Aluminum housing finished with corrosion free power coat
- Easy j-box access: snap on and off tool-less design

Driver Options:

- UNV: 120-277V Non-Dimmable
- THD: <20% (+/-5% tolerance), PF >0.9, 50/60Hz
- Flicker Free

Mounting & Installation:

- Surface mount into 30 or 40 j-box
- Optional 9' suspension kit available
- Optional 9' chain mount available

Certifications:

- ETL Listed for USA and CA
- Energy Star Listed
- Approved for CA T24
- 5 Year Limited Warranty
- FCC CFR 47, GCC Part 15, Subpart B:2017

Series	CCT	Sensor	Emergency	Optional Accessories (Order Separately)
LED-WRP-PRM-2FT-20W 20W • 1,900lm	35K 3500K	MS On/Off	EMB Emergency	Suspension Kits
LED-WRP-PRM-4FT-40W 40W • 3,800lm	40K 4000K	Sensor (HD407VC-R)	Bakup	SK-9FT-ADJ-2 9' Suspension Kit
	50K 5000K			CK-6FT-V 6' Chain Hanging Kit

Specs and model numbers are subject to change with or without notice.

Prismatic Lens LED Wraps

FEATURES

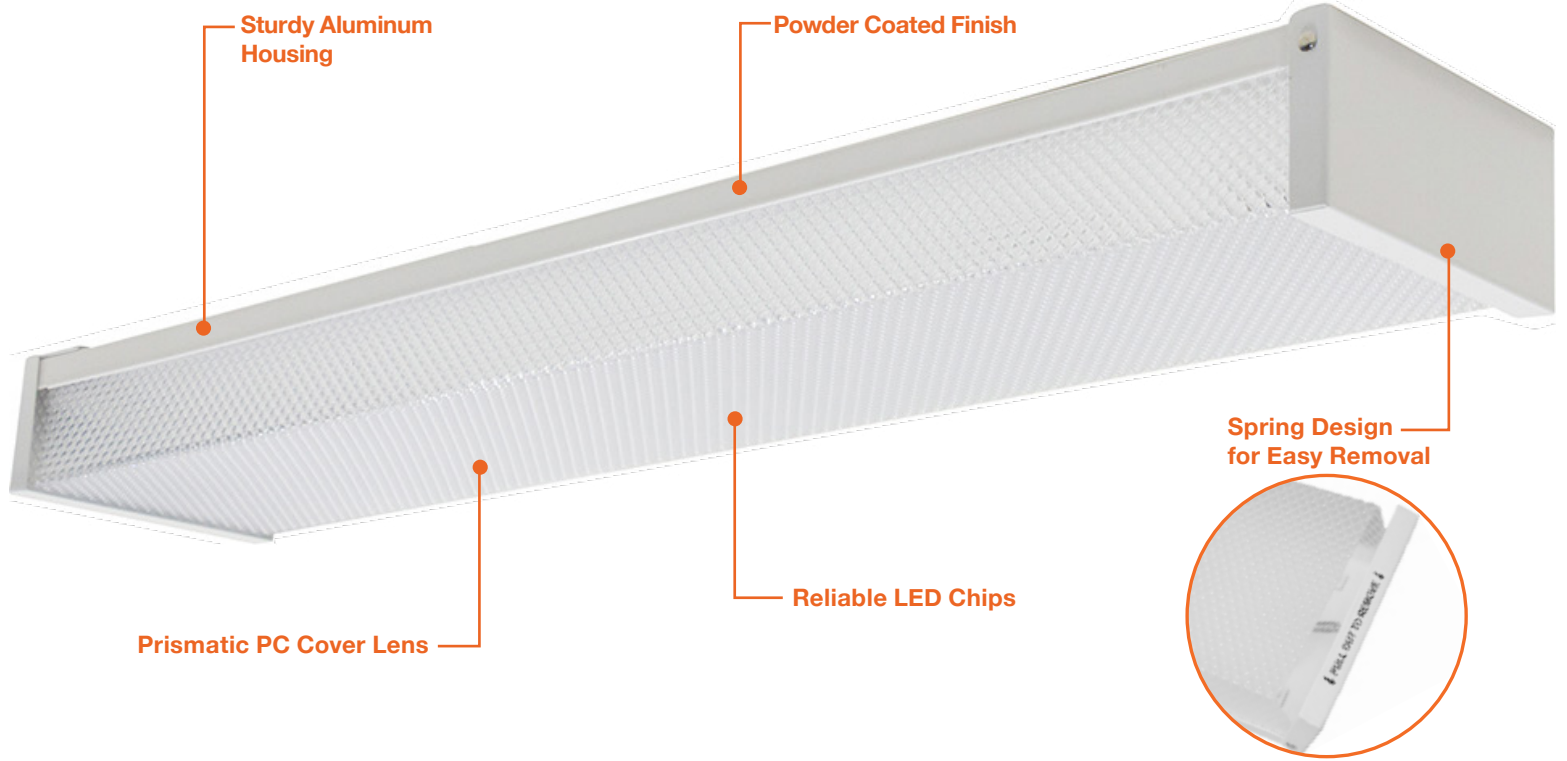

DIMENSIONS

2 Foot

2.37"

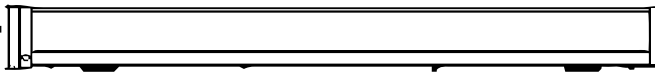

5.17"

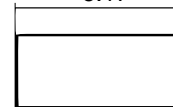

24.84"

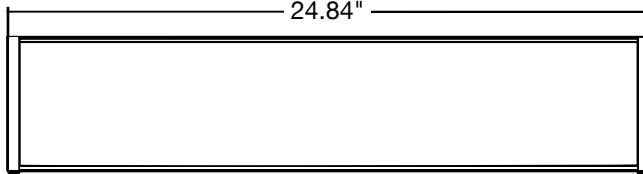

4 Foot

2.37"

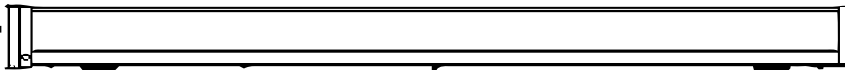

5.17"

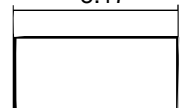

48.74"

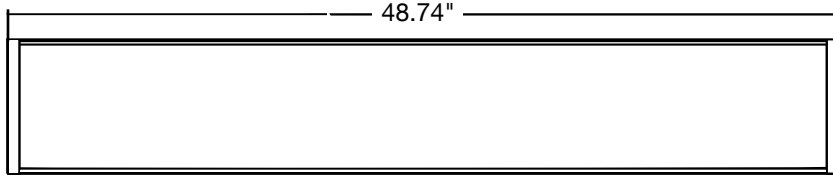

Prismatic Lens LED Wraps



SK-9FT-ADJ-2



CK-6FT-V



HD407V-CR

Model	Voltage	Watts	Lumens	Color	CRI
LED-WRP-PRM-2FT-20W-35K	120-277V	20w	1,900	3500k	>80
LED-WRP-PRM-2FT-20W-40K	120-277V	20w	1,900	4000k	>80
LED-WRP-PRM-2FT-20W-50K	120-277V	20w	1,900	5000k	>80
LED-WRP-PRM-4FT-40W-35K	120-277V	40w	3,800	3500k	>80
LED-WRP-PRM-4FT-40W-40K	120-277V	40w	3,800	4000k	>80
LED-WRP-PRM-4FT-40W-50K	120-277V	40w	3,800	5000k	>80

SUSPENSION KIT

Model	Description
SK-9FT-ADJ-2	9' Suspension Kit
CK-6FT-V	6' Chain Hanging Kit

SENSOR

Model	Item Description	Voltage	Watts
HD407V-CR	Bi Level Motion Sensor w/ Daylight Harvesting Detachable Version w/ external sensor -Remote Control Compatible	120-277V	<1w

Prismatic Lens LED Wraps

2' PRISMATIC LENS WRAPAROUND PHOTOMETRICS

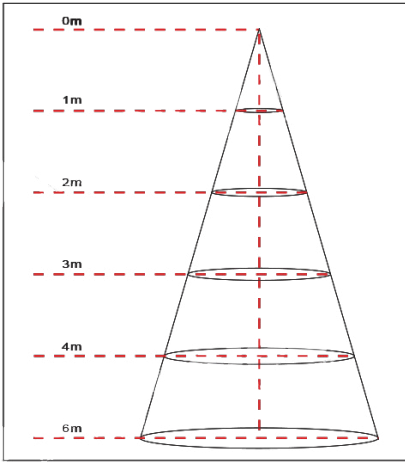

Height	Average Lux (lx)	Light range (dia.)
1M	308.9	208.66cm
2M	77.2	417.32cm
3M	34.3	525.99cm
4M	19.3	834.65cm
6M	12.4	1043.31cm

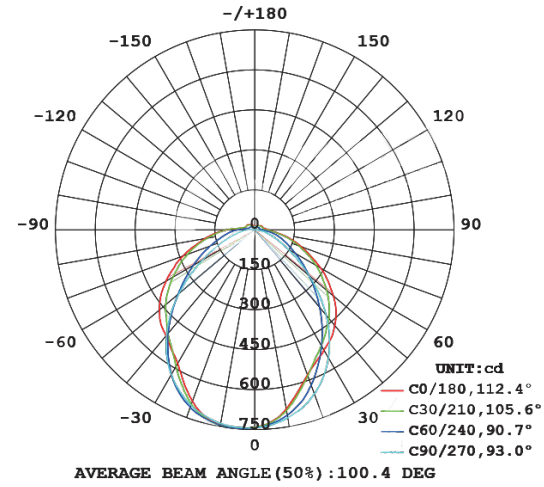

4' PRISMATIC LENS WRAPAROUND PHOTOMETRICS

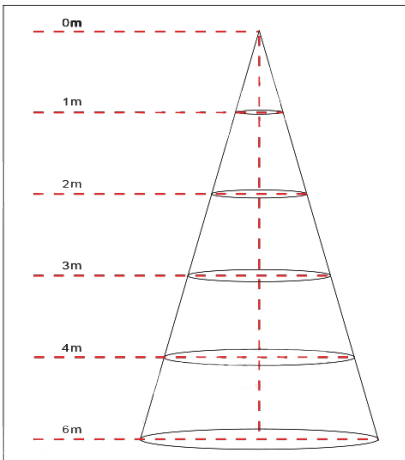

Height	Average Lux (lx)	Light range (dia.)
1M	595.6	215.07cm
2M	148.9	430.13cm
3M	66.2	645.2cm
4M	37.2	860.26cm
6M	23.8	1075.33cm

